

Effective pressure relief. Maximum value.

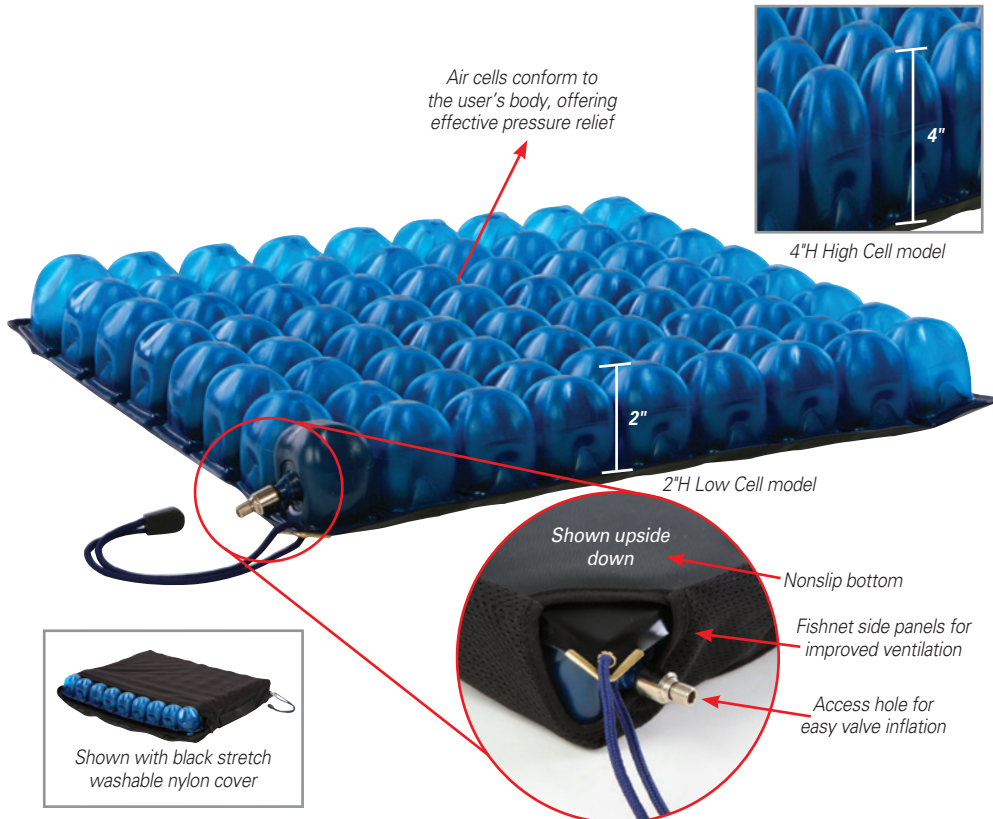

- Independent air cells mold to user's shape, relieving pressure
- Adjustable inflation for changing positioning needs
- Two height options for active or injury-prone users

AeroCell Wheelchair Cushions

Unlike solid foam cushions, which can bottom out or lose their shape, **AeroCell Cushions** distribute the user's weight evenly across individual air cells, reducing pressure points and shear forces while promoting blood circulation throughout the sitting area.

The cushion's interconnected cells can be inflated or deflated to fit distinct pressure-relief needs. **Single-Valve** inflation controls air pressure throughout the entire seat surface while **Dual-Valve** inflation features two independent chambers that permit each side to be inflated to a different degree of firmness for advanced positioning support.

Basic stability or extra support

Available in two heights:

- **2"H** for stability during frequent transfers
- **4"H** for maximum flotation for users at high risk for skin injury

Best for patients who:

- ✓ Sit for long periods of time and are at risk of bottoming out
- ✓ Self-propel or transfer frequently
- ✓ Are prone to pressure injuries



Choosing the right cushion—read our blog:
AliMed.com/choosing-a-cushion

See reverse for
ordering information 

Adaptable pressure relief



AeroCell™ Pressure-Relieving Cushions

Air cells provide exceptional pressure redistribution

Includes bulb inflator and Black stretch nylon washable cover with slip-resistant bottom • 2.25 lbs. • 440-lb. capacity • 1-year warranty

2"H LOW CELL

Single-Valve	Dual-Valve	Rep. Cover	Size
#10727	#10743	#1763	16"W x 16"D
#10728	#10744	—	16"W x 18"D
#10729	#10745	#1765	18"W x 16"D
#10731	#10746	#1766	18"W x 18"D
#10732	#10747	#1767	20"W x 18"D

4"H HIGH CELL

Single-Valve	Dual-Valve	Rep. Cover	Size
#11030	#11035	#1773	16"W x 16"D
#11031	#11036	#1774	16"W x 18"D
#11032	#11037	#1775	18"W x 16"D
#11033	#11038	#1776	18"W x 18"D
#11034	#11039	#1777	20"W x 18"D

Suggested code: K0736



Hinged to stay with chair when folded



AeroCell™ Stay-Put™ Cushions

Stays in place even when wheelchair is folded and stowed

2"H • Single-valve • Includes bulb inflator and Black stretch nylon cover with slip-resistant bottom • 2.25 lbs. • 440-lb. capacity • 2-year warranty

#10960 16"W x 16"D

#10961 18"W x 16"D

Patent #8,083,252 B2

Lower cost alternative to air cell



Independent Cell Cushions

Uniform pressure distribution, simple setup

4"H • Nylon waterproof cover • Navy

#1170 18"W x 16"D

#1171 16"W x 16"D



Underside ischial cutout: Foam is removed to reduce pressure

Super Wedge Cushions

Benefits of independent cell cushion plus wedge shape and ischial cutout

4"H tapers to 2½"H • Polyfoam • Nylon waterproof cover • Navy

#1172 18"W x 16"D

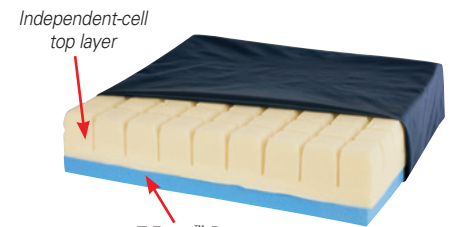

Independent-cell top layer

T-Foam™ Base

Checkerboard T-Foam™ Cushion Combo

Shock-absorbing T-Foam base

3"H • Nylon waterproof cover • Navy

#1217 18"W x 16"D

#1218 16"W x 16"D

Visit AliMed.com/cushions for our full line.

Any order placed before 3 p.m. EST, if in stock, ships the same day!

Prices, product availability, and specs are subject to change.

Pub. #7670 Product #11508

©2019 AliMed® Inc. All rights reserved. • Printed in USA.